

1. 在手机网络设置中打开移动数据 (Mobile data)
2. 在手机设置中找到个人热点设置，将热点 SSID 设置为 ali_mprov_ZL，密码设置为 9 个 1。
3. 打开个人热点。
4. 给滴定泵通电，操作复位按钮让滴定泵进入配网状态，然后等待滴定泵自动连接，连接成功后蓝灯常亮。
5. 找另外一台手机连接到个人热点，登录 App，在添加设备页面的 Local Devices 列表中可以看到该设备，选择绑定即可。

1. Turn on mobile data in mobile network settings
2. Find the personal hotspot settings in the phone settings, set the hotspot SSID to ali_mprov_ZL, and set the password to 111111111
3. Turn on personal hotspot.
4. Power on the dosing pump, operate the reset button to put the dosing pump into the network distribution state, and then wait for the dosing pump to connect automatically.
The blue light will stay on after success.
5. Find another mobile phone to connect to the personal hotspot, log in to the App, and find it in the Local Devices list on the Add Device page.
To see the device, select Bind.

How the dosing pump automatically connects to a specific hotspot

The following operation takes Xiaomi 9 equipped with Android 10 as an example.

1. Enter phone settings, in the setting of SIM cards & mobile networks, enable “Mobile data” to allow the phone to use mobile data.

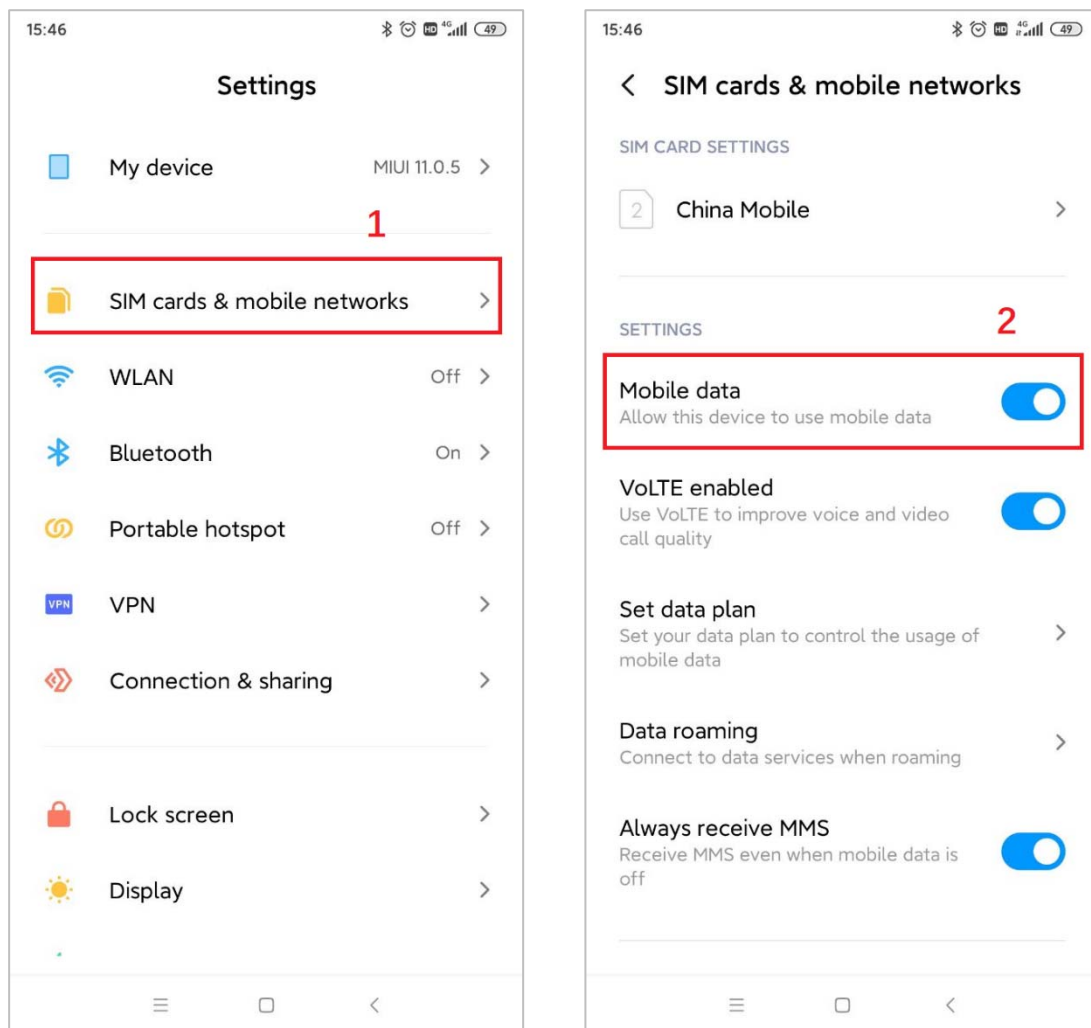

2. In the setting of Portable hotspot, enable “Portable hotspot”.

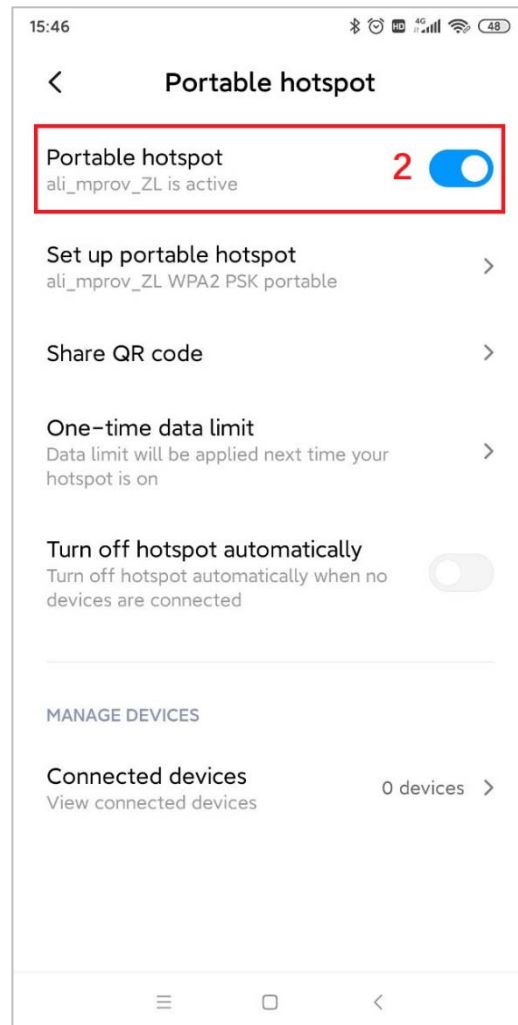
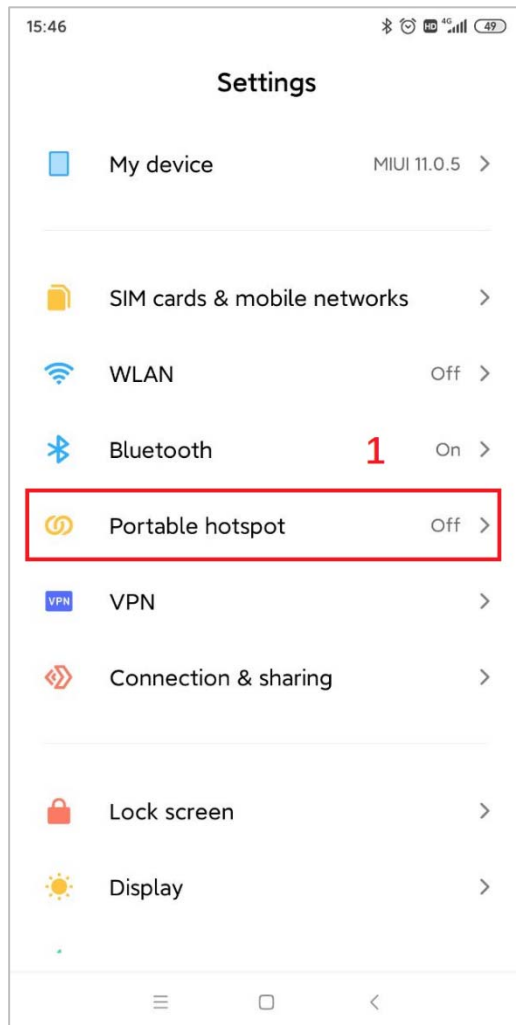

3. Setup portable hotspot as shown below. The password is nine ones.

15:46

Bluetooth, Alarm, HD, 4G, Signal, Wi-Fi, 48%

✕ Set up portable hotspot ✓

SSID 1 ali_mprov_ZL

Password 2 111111111

Security WPA2 PSK >

Device identification Portable hotspot >

Select AP Band 3 2.4 GHz Band >

4. Power up the dosing pump, operate the reset button to make the dosing pump enter the state of network configuration, the blue indicator flashes quickly at this time. Then wait for the dosing pump to automatically connect, and the blue indicator will be on after the connection is successful.